

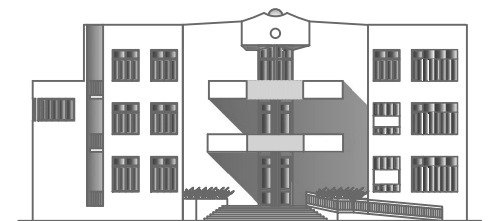

Regione Siciliana
CITTA' DI CASTELVETRANO
PROVINCIA REGIONALE DI TRAPANI



Visti



Elaborati Grafici

Piante scala 1:100

Oggetto:

*Suddivisione in 3 unità locali
del Centro Servizi integrato di
via Autonomia Siciliana*

Castelvetrano

Data _____



UNITA' LOCALE 1 - ATTIVITA' DI SERVIZIO



UNITA' LOCALE 2 - BAR-PASTICCERIA-GELATERIA



UNITA' LOCALE 3 - ZONA ESCLUSIVA PER L'ENTE



ZONE COMUNI

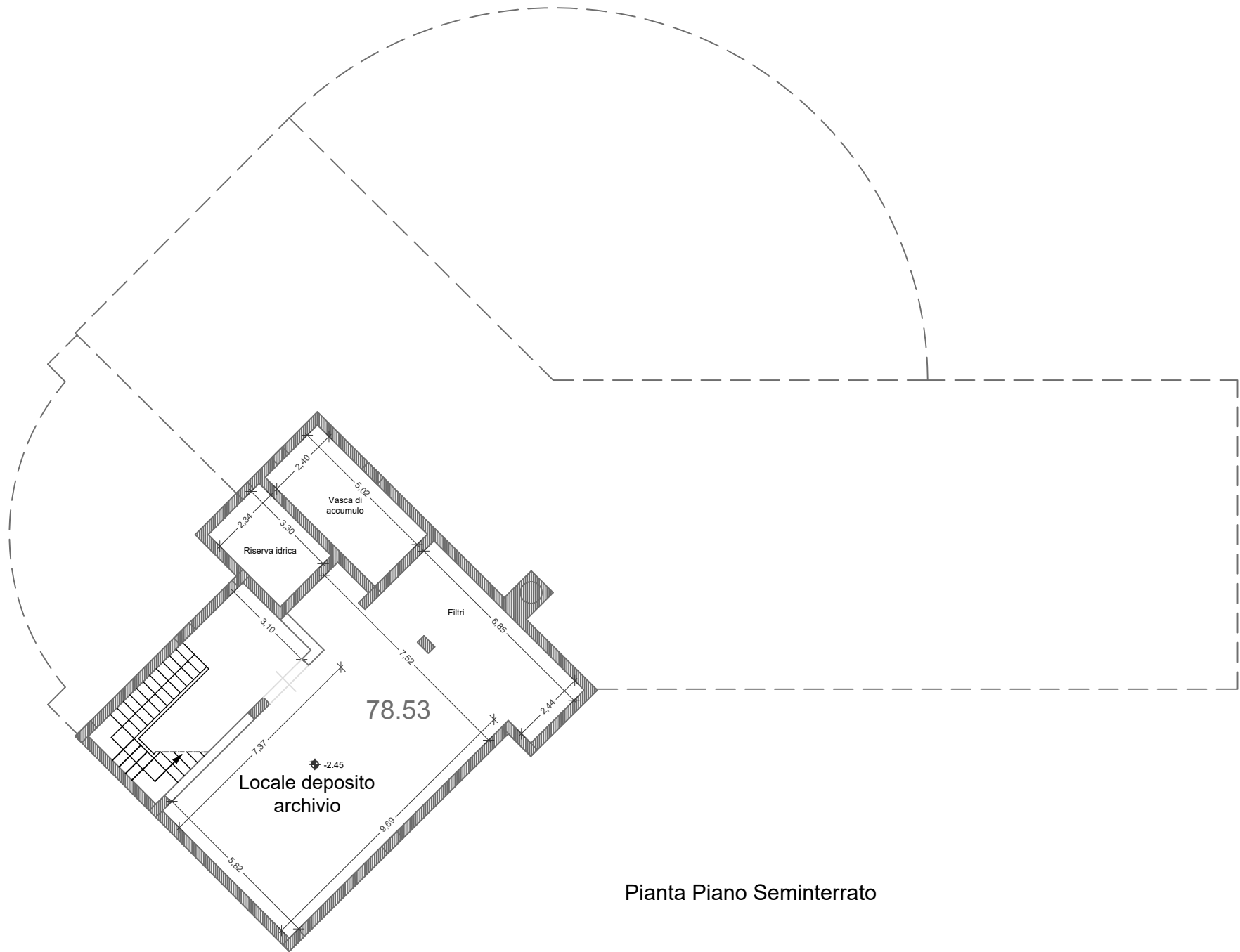

Pianta Piano Seminterrato

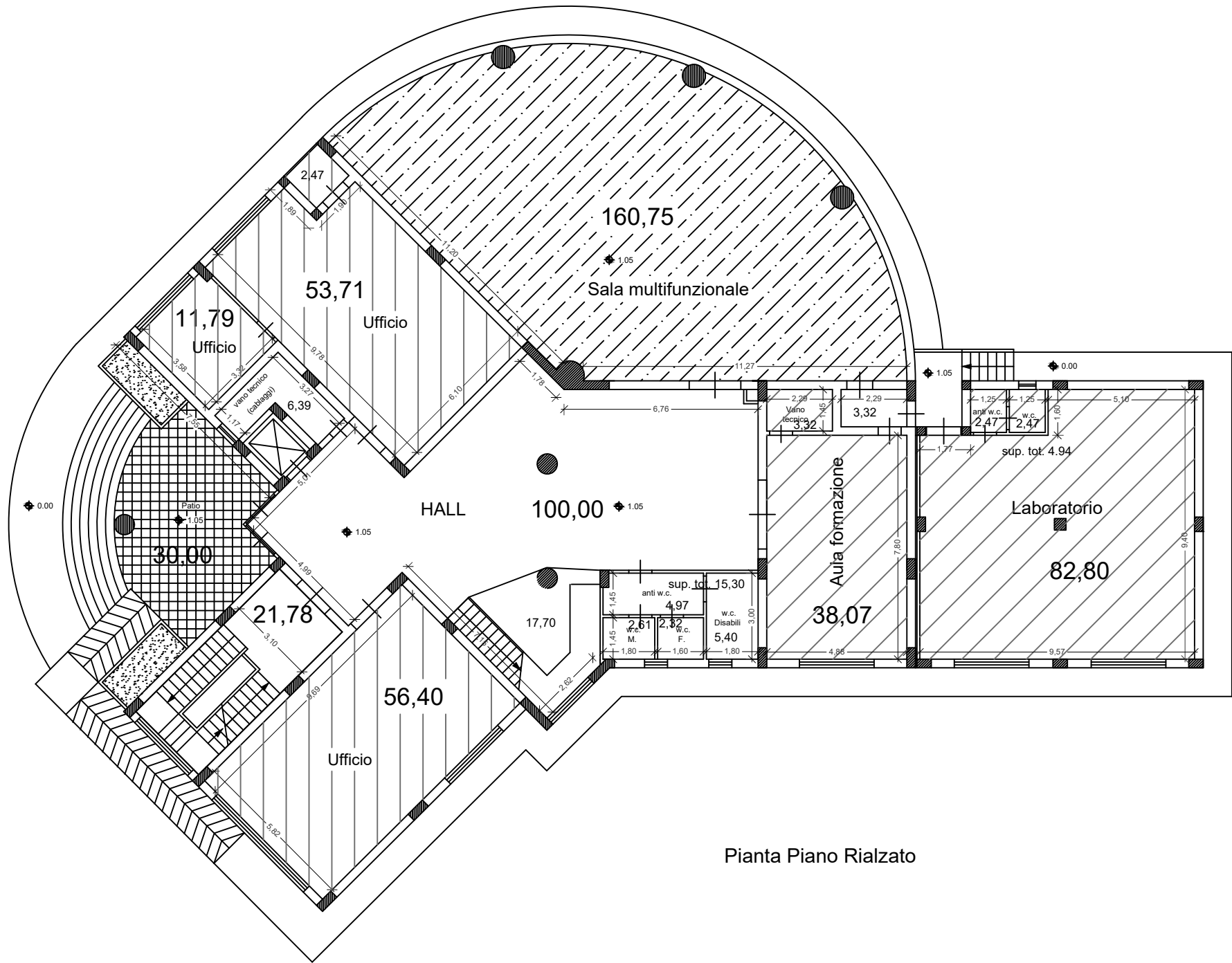

Pianta Piano Rialzato

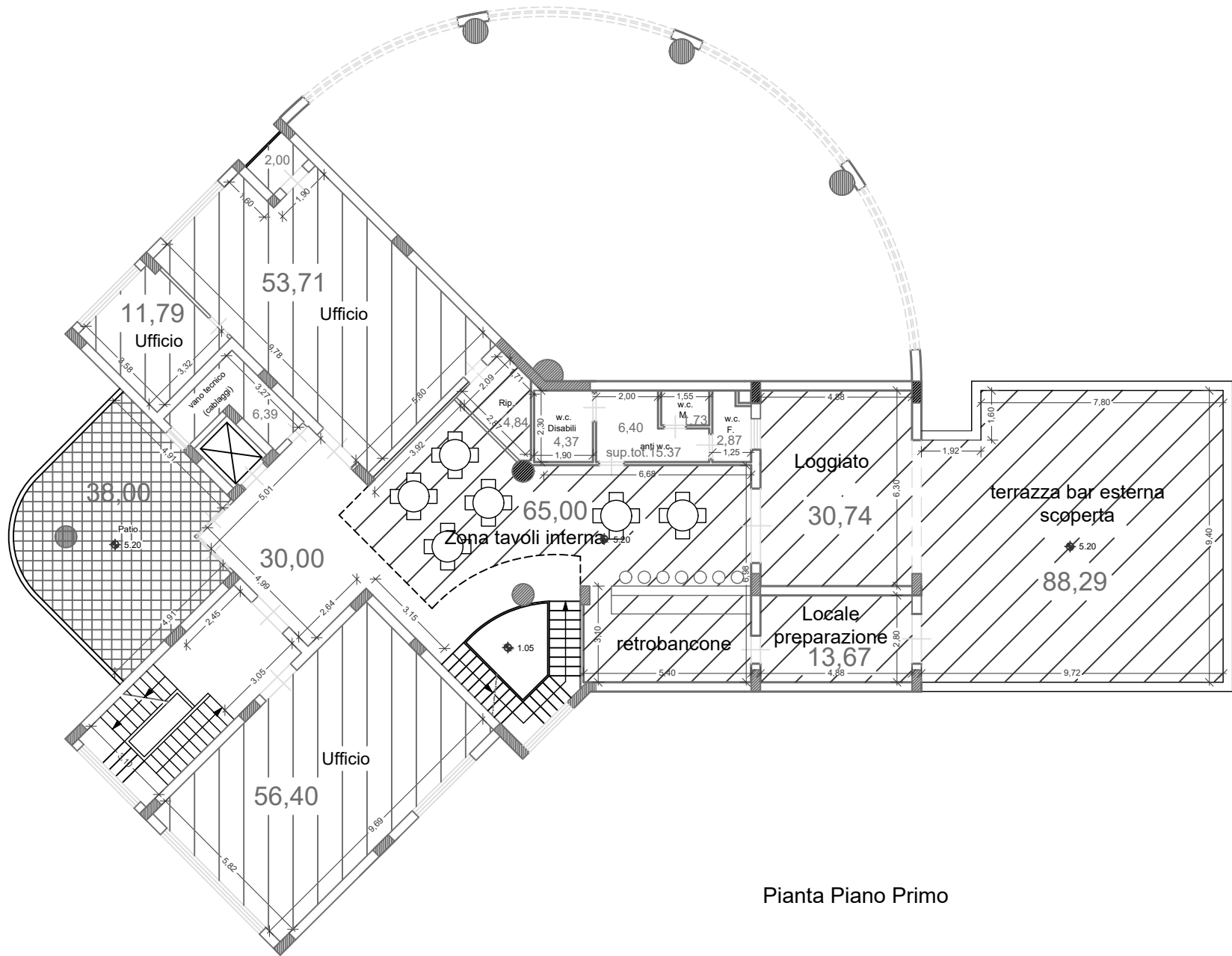

Pianta Piano Primo

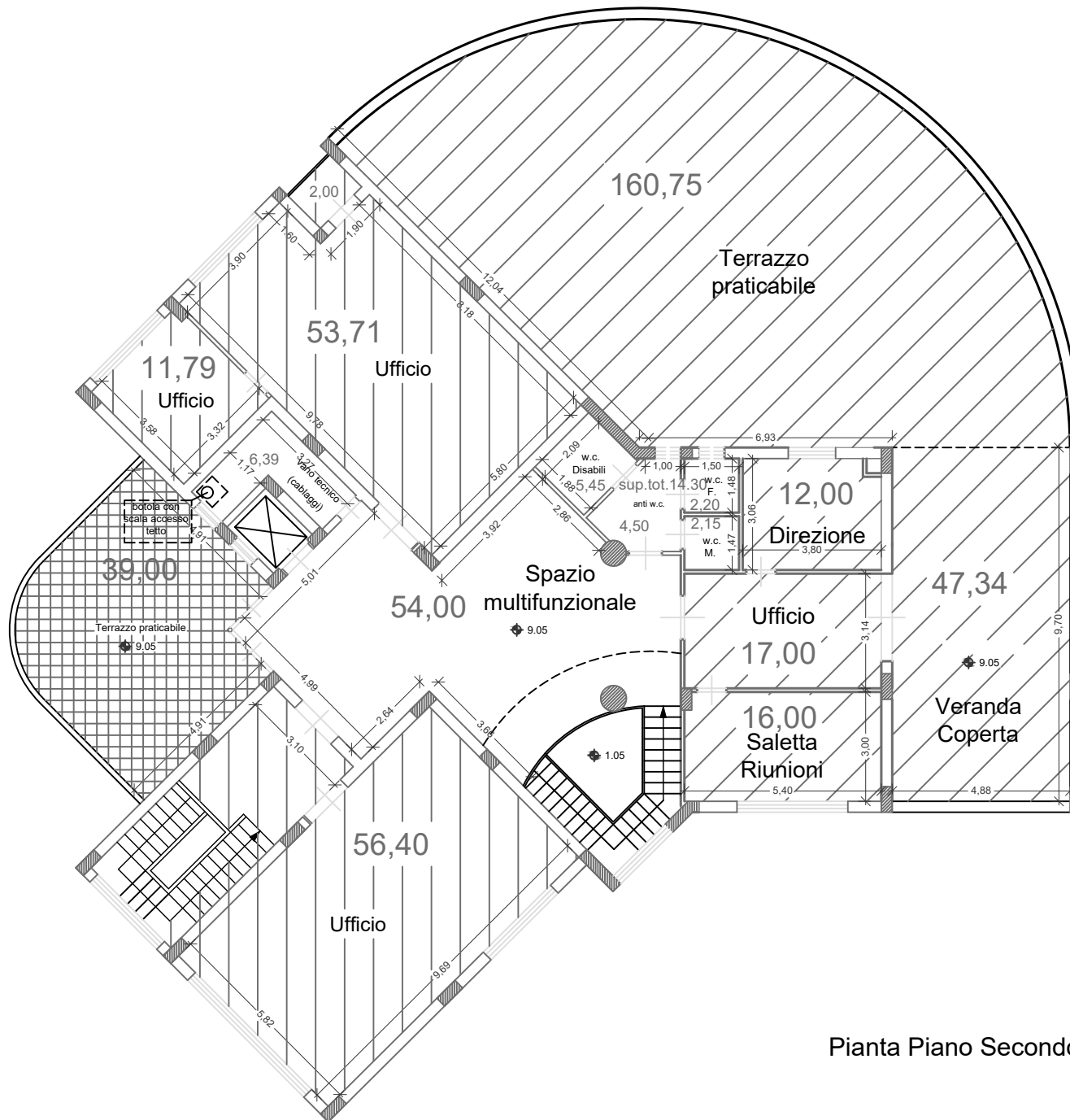

Pianta Piano Secondo

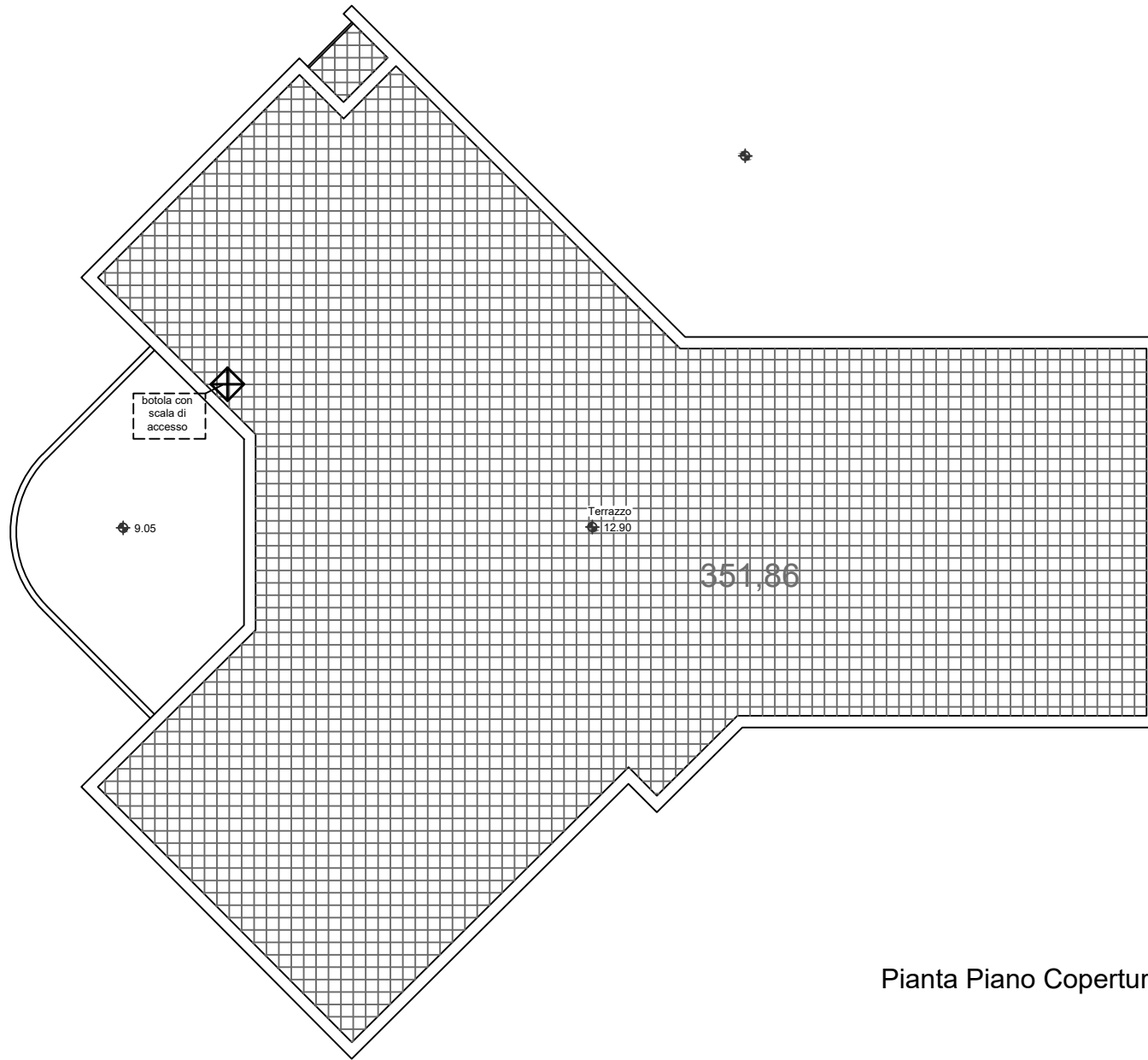

Pianta Piano Copertura